

YARD DUTY AND SUPERVISION POLICY



Help for non-English speakers

If you need help to understand the information in this policy please contact the school office on 9890 1560 or via email at surrey.hills.ps@education.vic.gov.au.

PURPOSE

To ensure school staff understand their supervision and yard duty responsibilities.

SCOPE

This policy applies to all teaching and non-teaching staff at Surrey Hills Primary School, including education support staff, casual relief teachers and visiting teachers.

POLICY

Appropriate supervision is an important strategy to monitor student behaviour and enables staff to identify and respond to possible risks at school as they arise. It also plays a vital role in helping schools to discharge their duty of care to students.

The Principal is responsible for ensuring that there is a well organised and responsive system of supervision and yard duty in place during school hours, before and after school, and on school excursions and camps and other school activities.

School staff are responsible for following reasonable and lawful instructions from the Principal, including instructions to provide supervision to students at specific dates, times and places. [Supervision should be undertaken in a way that identifies and mitigates risks to child safety.](#)

Before and after school

Surrey Hills Primary School's grounds are supervised by school staff from 8:50 am until 3:45 pm. Outside of these hours, school staff will not be available to supervise students.

Before and after school, school staff will supervise the school oval and roam between the front and rear entrance of the school.

Parents and carers will be advised through regular reminders in our newsletter that they should not allow their children to attend Surrey Hills Primary School outside of these hours. Families will be encouraged to contact the school office on 9890 1560 or refer to the school website for more information about the before and after school care facilities available to our school community.

If a student arrives at school before supervision commences at the beginning of the day, the Principal or nominee staff member will, as soon as practicable, follow up with the parent/carer to:

- advise of the supervision arrangements before school
- request that the parent/carer make alternate arrangements.

If a student is not collected before supervision finishes at the end of the day, the Principal or nominee staff member will consider whether it is appropriate to:

- attempt to contact the parents/carers
- attempt to contact the emergency contacts
- place the student in an out of school hours care program
- contact Victoria Police and/or Child Protection to arrange for the supervision, care and protection of the student.

Yard duty

All staff at Surrey Hills Primary School are expected to assist with yard duty supervision and will be included in the weekly roster for yard duty and first aid duty.

The Daily Organiser/Assistant Principal is responsible for preparing and communicating the yard duty roster via Compass and the daily bulletin daily.

At SHPS school staff will be designated a specific yard duty area to supervise on the weekly timetable that is updated daily to reflect absences and changes. The designated yard duty areas are NORTH and SOUTH. Two teachers are rostered on per session. All staff members are allocated an even number of yard duties throughout the week including extra-curricular clubs and activities.

Recess Duty 1:	11:00 am – 11:15 am
Recess Duty 2:	11:15 am - 11:30 am
Lunch Duty 1:	1:40 pm - 2:05 pm
Lunch Duty 2:	2:05 pm - 2:30 pm

In order to best care for the students and respect their colleagues, teachers must start their duty on time.

The teachers responsible for first recess or lunch duty are to collect a vest and yard duty bum bag from the school staffroom. When the second duty teacher comes out, these are to be handed over. The second yard duty teachers are to return vest and bum bag to staffroom at end of the recess and lunch break.

Each yard duty teacher has an allocated area in which they roam. Each teacher's allocated area is recorded on the daily bulletin to ensure that all areas of the school have a yard duty teacher accessible.

Yard duty zones

The designated yard duty areas for our school are:

North – Oval, Basketball Court, Outside Stadium, Junior and Senior Toilets

South – Prep and Junior Playground, Back of School (Valonia Street) Garden Beds and Four-Square Courts

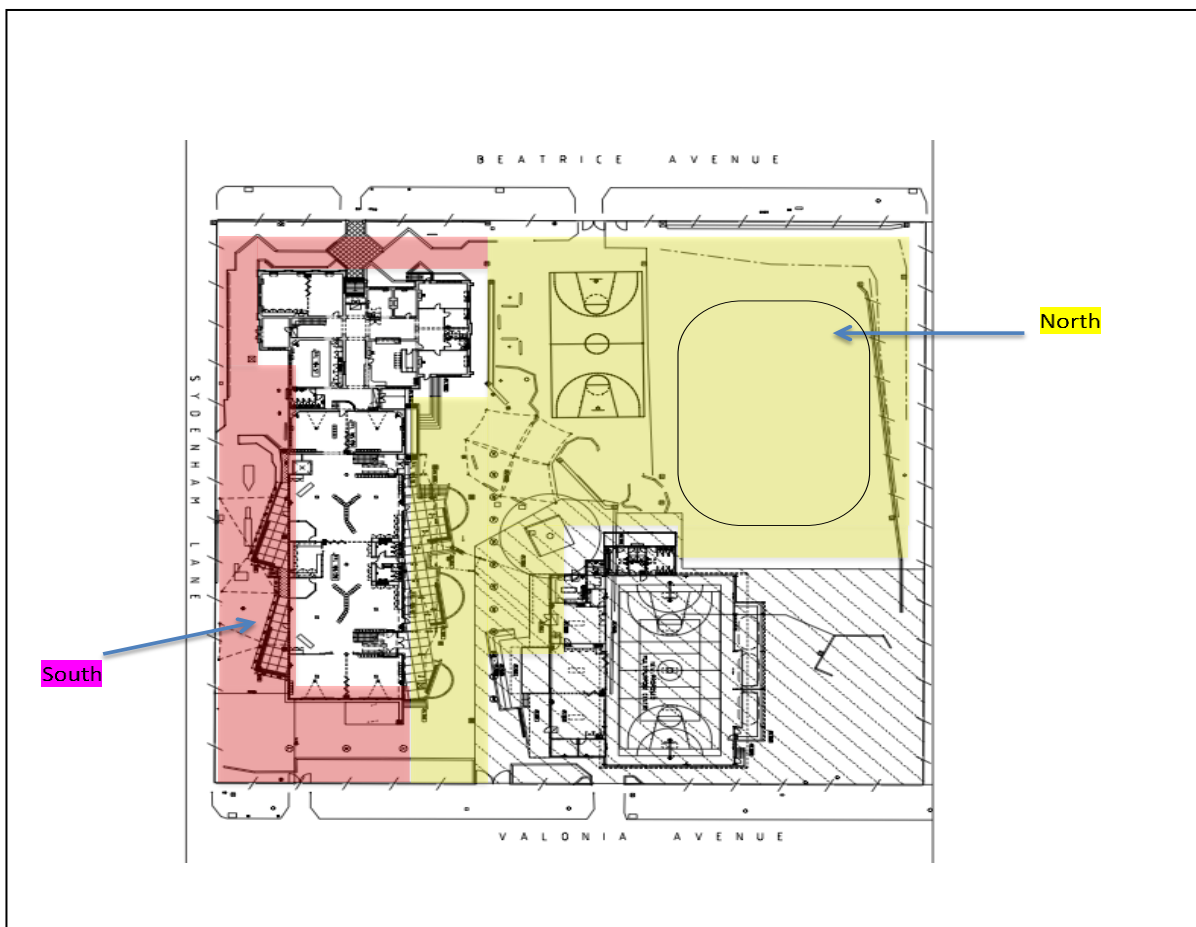

Yard duty equipment

School staff must:

- Wear a provided safety/hi-vis vest whilst on yard duty.
- Carry the yard duty first aid bag at all times during supervision.
- Safety/hi-vis vests will be stored in the staffroom with the yard duty bum bags.
- Be familiar with the yard duty information pack containing student health and safety information stored inside the bum bag.

Yard duty responsibilities

Staff who are rostered for yard duty must remain in the designated area until they are replaced by a relieving staff member.

During yard duty, supervising school staff must:

- Methodically move around the designated zone [ensuring active supervision of all students](#)
- Be alert and vigilant
- [where safe to do so, approach any unknown visitor who is observed on school grounds without a clear legitimate purpose, and ensure they have a visitor pass and have signed in \(excluding drop off and collection periods\)](#)

- Intervene immediately if potentially dangerous or inappropriate behaviour is observed in the yard
- Enforce behavioural standards and implement appropriate consequences for breaches of safety rules, in accordance with any relevant disciplinary measures set out in the school's Student Engagement policy
- Ensure that students who require first aid assistance receive it as soon as practicable
- Log any incidents or near misses as appropriate on Compass. Speak with the student's Homegroup teacher/Assistant Principal if issues need following up.
- To administer basic first aid (e.g. Band-Aids and reassurance where that is what's required)
- Only send students to Sick Bay inside if they require further medical attention
- Modelling appropriate yard behaviour (e.g. wearing hat in accord with SunSmart Policy), picking up rubbish, using appropriate language, etc)
- Restore friendships and problems between students using the Restorative Practices model and language.
- Facilitate connections between lonely students
- Monitor safe play
- Ensure students are in their correct playgrounds
- Be aware of students with special needs in the yard (i.e. behavioural and medical)
- Be aware of environmental issues (e.g. strangers in the yard, bee swarms, other animals)
- Advise office if it is raining sufficiently to call a wet day timetable
- Advise office if hot day/windy day/ extreme weather timetable should be called

If being relieved of their yard duty shift by another staff member (for example, where the shift is 'split' into 2 consecutive time periods), the staff member must ensure that a brief but adequate verbal 'handover' is given to the relieving staff member in relation to any issues which may have arisen during the first shift.

If the supervising staff member is unable to conduct yard duty at the designated time, they should contact the Assistant Principal with as much notice as possible prior to the relevant yard duty shift to ensure that alternative arrangements are made.

If the supervising staff member needs to leave yard duty during the allocated time, they should contact the Assistant Principal or an office staff member but should not leave the designated area until the relieving staff member has arrived in the designated area.

If the relieving staff member does not arrive for yard duty, the staff member currently on duty should send a message to the office and not leave the designated area until a relieving staff member has arrived.

Students will be encouraged to speak to the supervising yard duty staff member if they require assistance during recess or lunchtime.

Classroom

The classroom teacher is responsible for the supervision of all students in their care during class.

If a teacher needs to leave the classroom unattended at any time during a lesson, they should first contact their level team leader for assistance. The teacher should then wait until a replacement staff member has arrived at the classroom before leaving.

School activities, camps and excursions

The Principal and leadership team are responsible for ensuring that students are appropriately supervised during all school activities, camps and excursions, including when external providers are engaged to conduct part or all of the activity. Appropriate supervision will be planned for school activities, camps and excursions on an individual basis, depending on the activities to be undertaken and the level of potential risk involved, and will follow the supervision requirements in the Department of Education [Excursions Policy](#).

Digital devices and virtual classroom

Surrey Hills Primary School follows the Department's [Cybersafety and Responsible Use of Technologies Policy](#) with respect to supervision of students using digital devices.

Surrey Hills Primary School will also ensure appropriate supervision of students participating in remote and flexible learning environments while on school site. In these cases, students will be supervised and will undertake virtual and remote learning in one of the learning zones. Students will be supervised by a teacher or member of school leadership during recess and lunch breaks.

While parents are responsible for the appropriate supervision of students accessing virtual classrooms from home:

- student attendance will be monitored daily
- any wellbeing or safety concerns for the student will be managed in accordance with our usual processes – refer to our Student Wellbeing and Engagement Policy and our Child Safety Responding and Reporting Policy and Procedures for further information.

Students requiring additional supervision support

Sometimes students will require additional supervision, such as students with disability or other additional needs. In these cases, the Principal or delegate will ensure arrangements are made to roster additional staff as required. This may include on yard duty, in the classroom or during school activities.

Supervision of student in emergency operating environments

In emergency circumstances our school will follow our Emergency Management Plan, including with respect to supervision.

In the event of any mandatory period of remote or flexible learning our School will follow the operations guidance issued by the Department.

COMMUNICATION

This policy will be communicated to our school community in the following ways:

- Included in staff induction processes
- Discussed at staff briefings or meetings, as required
- Included in our staff handbook
- Made available in hard copy from school administration upon request

Information for parents and students on supervision before and after school is available on our school website and parent reminders are sent at the beginning of the year in our school newsletter.

FURTHER INFORMATION AND RESOURCES

- the Department’s Policy and Advisory Library (PAL):
 - [Child Safe Standards](#)
 - [Cybersafety and Responsible Use of Technologies](#)
 - [Duty of Care](#)
 - [Excursions](#)
 - [Supervision of Students](#)
 - [Visitors in Schools](#)

POLICY REVIEW AND APPROVAL

Policy last reviewed	March 2024
Approved by	Principal
Next scheduled review date	March 2026

This policy will also be updated if significant changes are made to school grounds that require a revision of Surrey Hills Primary School’s yard duty and supervision arrangements.